

# AQUA CLICK TILES

## SPC vinyl tiles for floors and walls

100%  
WATERPROOF

15  
YEAR  
GUARANTEE

CLICK4U®

FALL DOWN

MICRO BEVEL

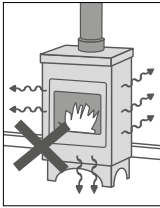
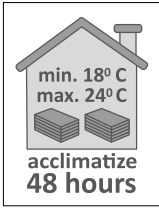

Use a shower tray in the shower

Keep the tiles at room temperature (between 18°C and 24°C) for at least 48 hours before you start the installation. SPC vinyl tiles can be installed on underfloor heating but the surface should not exceed 27°C.

The tiles are briefly resistant to temperatures up to 75°C. The tiles should not be constantly exposed to higher temperatures, installation in a conservatory for example is not recommended.

Aqua Click Tiles are only suitable for use indoor and should be installed and stored in a room that is heated.

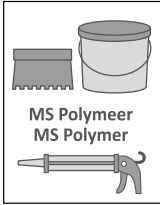
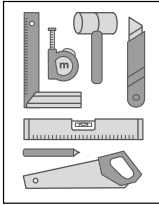

MS Polymer  
MS Polymer

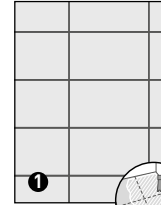
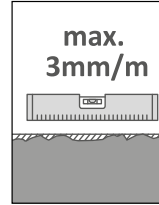
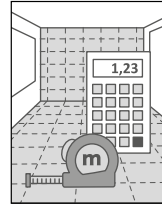
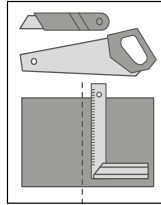

full surface  
gluing method

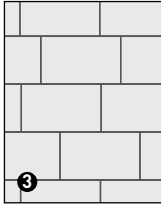
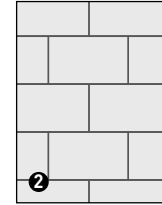

### FLOOR AND WALL INSTALLATION

The following tools are needed: a rubber hammer (light coloured rubber), set square, tape measure, spirit level, glue gun or glue comb, glue (MS polymer), saw or Stanley knife and a pencil. The subfloor must be dry, pressure resistant and free from dust and dirt. Check the wall/floor for flatness. The unevenness should not exceed 3mm under a straight ruler of 1 meter, even up if necessary. Tile joints should be no more than 6 mm

wide. If a click joint is right on top of a tile joint, the joint should be levelled. Measure the wall/floor and make a drawing to divide the tiles nicely over the surface. The tiles can be installed in a straight line ①, brick ② or staggered ③ overlap minimum of 30cm) pattern. Inspect the tiles before installation for visible defects. Tiles with visible defects should not be installed. After installation a claim will not

be accepted. On the long sides of the tiles there is a click joint "Click4U" on the short sides a Fall-down "3L Triplelock". To join 2 tiles, place the tongue of one tile into the groove of another tile under an angle of 45 degrees, move the tile towards the butt end of the previous tile and push it down. Tap it with a hammer carefully over the whole width until the short sides click together.

Tiles can be cut to size using a try square and a Stanley knife. The tile is cut and then broken over the breaking line.

#### 1 Full surface gluing method

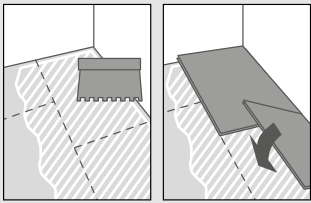

#### 2 Floating floor

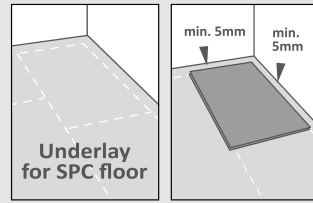

Underlay  
for SPC floor

min. 5mm  
min. 5mm

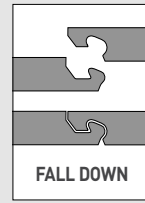
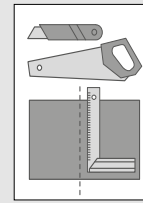

FALL DOWN

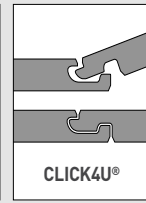
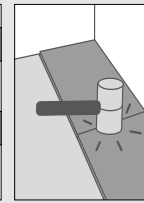

CLICK4U®

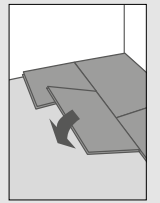

### LAYING THE FLOOR

**1 Full surface gluing method:** use a MS polymer adhesive and apply it with a glue spreader comb (check the packaging for the right spreader). First degrease the subfloor and the back of the tiles.

**2 Aqua Click Tiles are suitable for laying in a floating manner.** It is recommended to lay a sound absorbing barrier suitable for SPC floors such as the HDM segura LVT Click Smart N underlay. Leave a 5mm expansion gap open on all sides when the length / width

of the floor does not exceed 5 meters. For a longer / wider floor, add 1mm per linear meter. The maximum floor length without expansion joint is 12 x 8 meter. Fix the first row with distance wedges on the wall. The first row is laid with the tongue of the long

side of the tile facing the wall. Always click the tongue into the groove. When the tiles are installed in a straight line and/or in rooms with humid conditions we recommend the full surface gluing method.

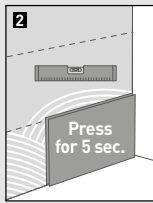
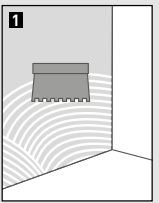

Press  
for 5 sec.

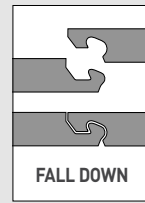
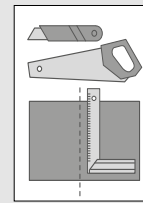
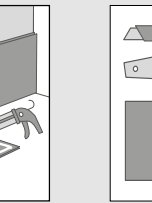
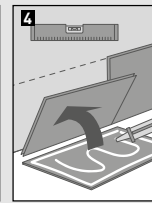
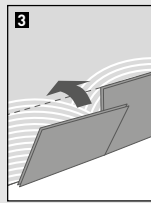

FALL DOWN

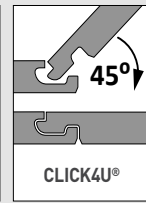
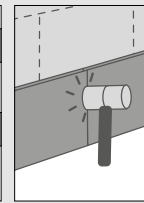

CLICK4U®

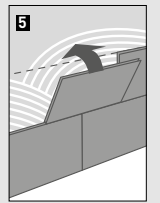

### INSTALLATION ON THE WALL

First degrease the wall and the back of the tiles. Take a ruler and a spirit level and draw a reference line with a pencil before starting the fitting. Press the tile for 5 seconds after fitting. Keep a cleaning product at hand for removing excess glue. Start the installation at the

bottom and work from right to left always clicking the tongue in the groove.  
**Option 1:** Apply the MS polymer adhesive with a glue comb on the wall (fig 1-3)  
**Option 2:** Apply the adhesive with a cartridge gun on the back of the tile all around and in the middle as shown in fig. 4.

When fitting on a plaster board base make sure the joints of the tiles do not coincide with the seams of the plaster boards. Place the first tile in the bottom right corner. Fit the tiles of the first row one-by-one with the short sides together. Install the next row as described above. Check after every row if

the joints are perfectly aligned and the tiles are still level, before the adhesive is dry. Once the two first rows have been fitted, fit the other tiles row by row.

### FINISH AND MAINTENANCE

Holes for piping, screws or joinings: drill the holes first in the panels before gluing them. Use an appropriate tool. The diameter of the holes must be at least 10 mm larger than the hose or joining. Fill the hole up with moisture resistant silicone after fixing the panels. For finishing use a moisture resistant silicone or a suitable profile which is glued onto the panels. For external corners use a

suitable profile. For finishing in a shower use a moisture resistant silicone between wall and shower tray. For finishing the ceiling use silicone or a suitable profile which is glued onto the panels. Clean the panels with a moist cloth. Use a vacuum cleaner suitable for hard surface floors, a soft brush, or an active fibre dry mop. Never clean the surface of the panels with

polish, wax, varnish, bleach, scouring pads, wire wool, abrasives, or cleansing agents that contain abrasives or bleach. The use of a steam cleaner is not recommended for these floors.

For more tips and up-to-date instructions: [www.hdm.be](http://www.hdm.be)

**aqua step**  
100% WATERPROOF BY HDM